

**Wafer Butterfly Valve
Gear Operated, 300PSI
FIG · F0811-300**

Specification

- Single piece through shaft.
- Vulcanized seat design for bubble-tight shutoff at 300 psi.
- Flag type position indicator.
- Low torque operation, high cycle life.
- With built-in supervisory switch.
- Top flange to ISO 5211/1.
- Flanges designed to EN1092-2 PN10 / PN16, ANSI B16.1 Class125 (Other types available on request).
- UL listed.

Working Pressure

- 300PSI
- 200PSI and 250PSI available on request

Working Temperature

- 0.6°C to 52°C

Corrosion Protection

- Internally and externally fusion bonded epoxy powder coated (FBE).

Notes: Design and material are subject to change without notice.

Drawing and Picture



Installation of Gear Operator With Tamper Switch

Butterfly valves are provided with internal supervisory position switches. The tamper switch operates by a cam connected to the valve stem. The switch will change position and close within two (2) full turns of the handwheel from the fully open position.

Switch #1:

For connection to the supervisory circuit

Normally closed: 2 Yellow

Normally open: 2 Red

Common: 2 White

Switch #2:

Auxiliary switch connected per authority

Normally closed: 1 Blue

Normally open: 1 Orange

Common: 1 Black

Ground Lead: 1 Green

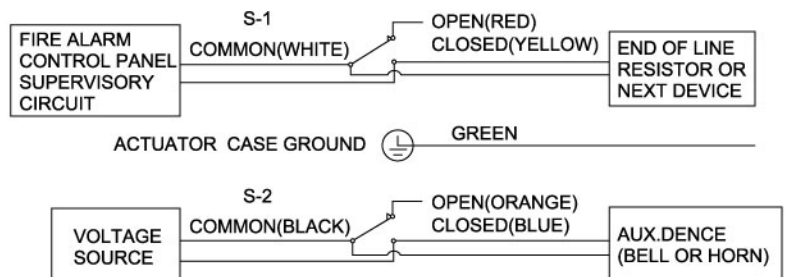

- NOTES 1. Item No. : VSION 021 C2
2. Rated : 10A 125-250VAC

Wafer Butterfly Valve
Gear Operated, 300PSI
FIG · F0811-300

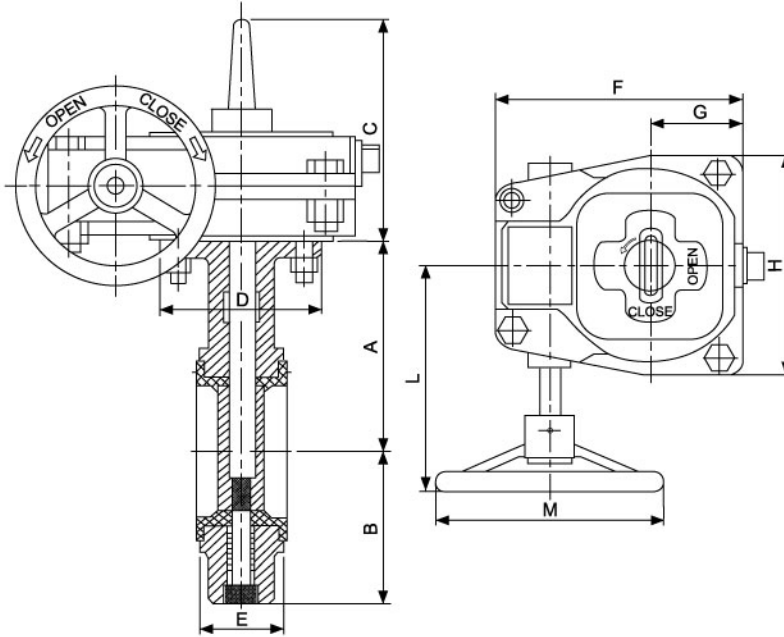

Material Specification

	Part Name	Material	EN Spec.	ASTM Spec.
Valve	Body	Ductile Iron	EN-JS1050	A536 65-45-12
	Disc	Ductile Iron	EN-JS1050	A536 65-45-12
	Shaft	Stainless Steel	BS970 431S29	AISI 431
	Bushing	Brass	CuZn39Pb3	B16 C36000
Gear Operator	Housing	Cast Iron	EN-JL1040	A126 Class B
	Cover	Cast Iron	EN-JL1040	A126 Class B
	Wormgear	Brass	CuZn39Pb3	B16 C36000
	Worm	Stainless Steel	BS970 420S37	AISI 420
	Handwheel	Cast Iron	EN-JL1040	A126 Class B

Dimensions (mm/inch)

Size	A	B	D	E	C	F	G	H	L	M
DN50	110	74	90	43	120	170	65	155	150	200
DN65	118	85	90	46						
DN80	130	95	90	46						
DN100	145	115	90	51.5						
DN125	160	130	90	56						
DN150	175	145	90	56.5	160	225	85	206	200	300
DN200	200	170	125	60						
DN250	250	208	125	68.5						
DN300	275	237.5	125	79.5						

**Groove Butterfly Valve
Gear Operated, 300PSI
FIG · F1022-300**

Specification

- Vulcanized disc design for bubble-tight shutoff at 300 psi.
- Flag type position indicator.
- Low torque operation, high cycle life.
- With built-in supervisory switch.
- Top flange to ISO 5211/1.
- With groove to Metric or AWWA C606 standard.
- UL listed.

Working Pressure

- 300PSI
- 200PSI and 250PSI available on request

Working Temperature

- 0.6°C to 52°C

Corrosion Protection

- Internally and externally fusion bonded epoxy powder coated (FBE).

Notes: Design and material are subject to change without notice.

Drawing and Picture



Installation of Gear Operator With Tamper Switch

Butterfly valves are provided with internal supervisory position switches. The tamper switch operates by a cam connected to the valve stem. The switch will change position and close within two (2) full turns of the handwheel from the fully open position.

Switch #1:

For connection to the supervisory circuit

Normally closed: 2 Yellow

Normally open: 2 Red

Common: 2 White

Switch #2:

Auxiliary switch connected per authority

Normally closed: 1 Blue

Normally open: 1 Orange

Common: 1 Black

Ground Lead: 1 Green

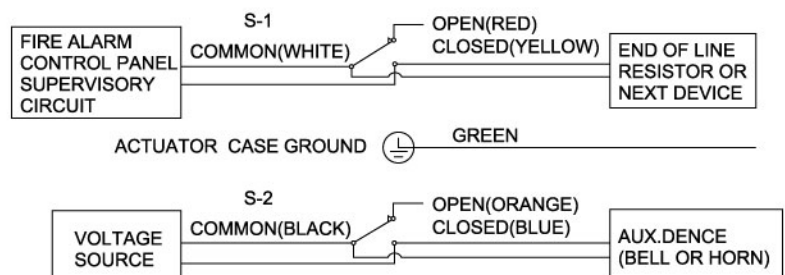

- NOTES
1. Item No. : VSION 021 C2
 2. Rated : 10A 125-250VAC

Groove Butterfly Valve
Gear Operated, 300PSI
FIG · F1022-300

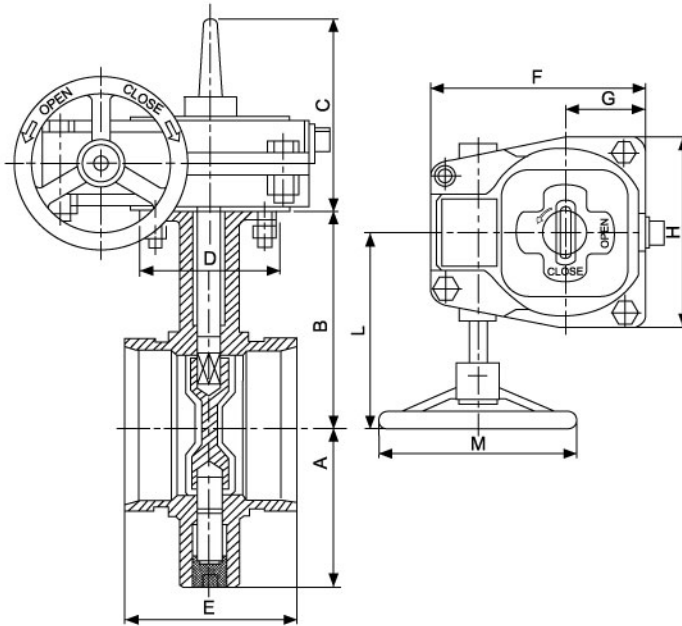

Material Specification

	Part Name	Material	EN Spec.	ASTM Spec.
Valve	Body	Ductile Iron	EN-JS1050	A536 65-45-12
	Disc	Ductile Iron, EPDM coated	EN-JS1050	A536 65-45-12
	Shaft Upper	Stainless Steel	BS970 431S29	AISI 431
	Shaft Lower	Stainless Steel	BS970 431S29	AISI 431
	Bushing	Brass	CuZn39Pb3	B16 C36000
Gear Operator	Housing	Cast Iron	EN-JL1040	A126 Class B
	Cover	Cast Iron	EN-JL1040	A126 Class B
	Wormgear	Brass	CuZn39Pb3	B16 C36000
	Worm	Stainless Steel	BS970 420S37	AISI 420
	Handwheel	Cast Iron	EN-JL1040	A126 Class B

Dimensions (mm/inch)

Size	A	B	D	E	C	F	G	H	L	M
DN50	77	99	90	84	120	170	65	155	150	200
DN65	85	112	90	97						
DN80	90	115	90	97						
DN100	108	145	90	116						
DN125	120	138.5	90	148						
DN150	145	185	90	148	160	225	85	206	200	300
DN200	180	200	125	133						
DN250	230	250	125	159						
DN300	260	275	125	165						

OS&Y RESILIENT SEALED GATE VALVE FLANGE ENDS 200PSI **FIG · F0111-200**

Specification

- Valves comply with AWWA C515
- The handwheel is attached to the yoke by a heavier nut.
- High quality graphite stem seal.
- NPT brass plug on body.
- One brass plug screwed on body
- Flanges EN1092-2 PN10 / PN16, ANSI B16.1 Class125 (Others available on request).
- FM and UL approved

Working Pressure

- 200PSI

Working Temperature

- 0.6°C to 52°C

Corrosion Protection

- Internally and externally fusion bonded epoxy powder coated (FBE).

Notes: Design and material are subject to change without notice.

Material Specification

Part Name	Material	ASTM Spec.
Body	Ductile Iron	A536 65-45-12
Wedge	Ductile Iron, EPDM Encapsulated	
Wedge Nut	Stainless Steel	AISI 304
Stem	Stainless Steel	AISI 420
Bonnet	Ductile Iron	A536 65-45-12
Gasket	EPDM	Commercial
Packing	Graphite	Commercial
Gland	Ductile Iron	A536 65-45-12
Yoke Nut	Bronze	ASTM B62
Handwheel	Ductile Iron	A536 65-45-12
Handwheel Nut	Ductile Iron	A536 65-45-12
NPT Plug	Brass	B16, C36000
Gland Bolts	Stainless Steel	AISI 316
Bonnet Bolts	Carbon Steel	A307 B

Drawing and Picture

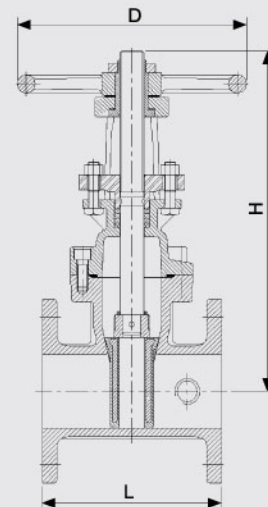

Dimensions (mm/inch)

Size	2.5"		3"		4"		5"		6"		8"		10"		12"	
	mm	inch	mm	inch	mm	inch	mm	inch	mm	inch	mm	inch	mm	inch	mm	inch
L	190.5	7-1/2	203	8	229	9	254	10	267	10-1/2	292	11-1/2	330	13	356	14
H(Open)	415	16-5/8	480	18-7/8	550	21-5/8	655	25-4/5	740	29-1/8	930	36-5/8	1130	44-1/2	1320	52
H(Close)	350	13-3/4	400	15-3/4	450	17-3/4	530	20-7/8	590	23-1/4	730	28-3/4	880	34-3/4	1020	40-1/6
D	184	7-1/4	254	10	254	10	305	12	305	12	356	14	445	17-1/2	445	17-1/2
Weigh(kg)	20		25		30		42		50		77		120		170	



OS&Y RESILIENT SEALED GATE VALVE FLANGE ENDS 250PSI FIG · F0111-250

Specification

- Valves comply with AWWA C515
- The handwheel is attached to the yoke by a heavier nut.
- High quality graphite stem seal.
- NPT brass plug on body.
- One brass plug screwed on body
- Flanges EN1092-2 PN10 / PN16, ANSI B16.1 Class125 (Others available on request).
- FM and UL approved

Working Pressure

- 250PSI

Working Temperature

- 0.6°C to 52°C

Corrosion Protection

- Internally and externally fusion bonded epoxy powder coated (FBE).

Notes: Design and material are subject to change without notice.

Material Specification

Part Name	Material	ASTM Spec.
Body	Ductile Iron	A536 65-45-12
Wedge	Ductile Iron, EPDM Encapsulated	
Wedge Nut	Stainless Steel	AISI 304
Stem	Stainless Steel	AISI 420
Bonnet	Ductile Iron	A536 65-45-12
Gasket	EPDM	Commercial
Packing	Graphite	Commercial
Gland	Ductile Iron	A536 65-45-12
Yoke Nut	Bronze	ASTM B62
Handwheel	Ductile Iron	A536 65-45-12
Handwheel Nut	Ductile Iron	A536 65-45-12
NPT Plug	Brass	B16, C36000
Gland Bolts	Stainless Steel	AISI 316
Bonnet Bolts	Carbon Steel	A307 B

Drawing and Picture

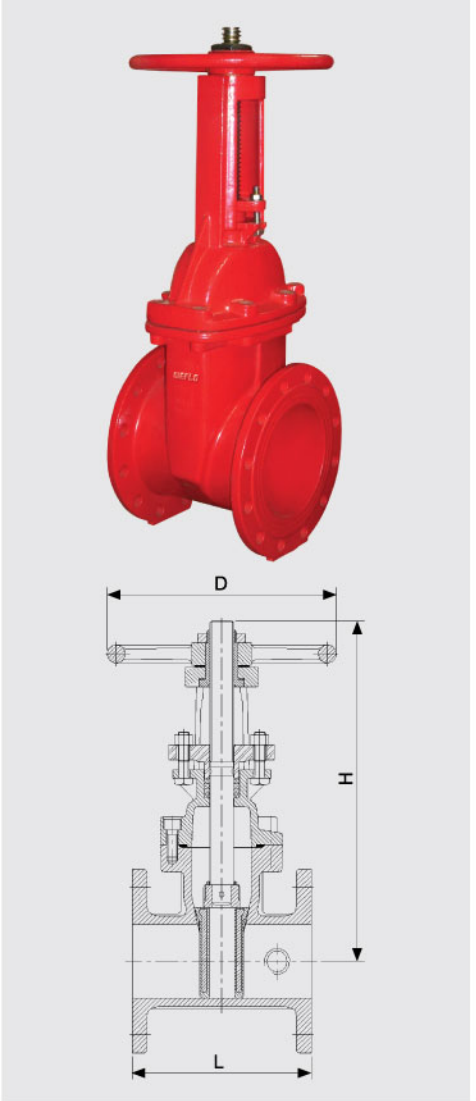

Dimensions (mm/inch)

Size	2.5"		3"		4"		5"		6"		8"		10"		12"	
	mm	inch	mm	inch	mm	inch	mm	inch	mm	inch	mm	inch	mm	inch	mm	inch
L	190.5	7-1/2	203	8	229	9	254	10	267	10-1/2	292	11-1/2	330	13	356	14
H(Open)	415	16-5/8	480	18-7/8	550	21-5/8	655	25-4/5	740	29-1/8	930	36-5/8	1130	44-1/2	1320	52
H(Close)	350	13-3/4	400	15-3/4	450	17-3/4	530	20-7/8	590	23-1/4	730	28-3/4	880	34-3/4	1020	40-1/6
D	184	7-1/4	254	10	254	10	305	12	305	12	356	14	445	17-1/2	445	17-1/2
Weigh(kg)	20		25		30		42		50		77		120		170	

**OS&Y RESILIENT SEALED GATE VALVE
FLANGE ENDS 300PSI
FIG · F0111-300**

Specification

- Valves comply with AWWA C515.
- The handwheel is attached to the yoke by a heavy duty nut.
- High quality graphite stem seal.
- NPT brass plug on body.
- Flanges EN1092-2 PN10 / PN16, ANSI B16.1 Class125 (Others available on request).
- FM and UL approved.

Working Pressure

- 300PSI

Working Temperature

- 0.6°C to 52°C

Corrosion Protection

- Internally and externally fusion bonded epoxy powder coated (FBE).

Notes: Design and material are subject to change without notice.

Material Specification

Part Name	Material	ASTM Spec.
Body	Ductile Iron	A536 65-45-12
Wedge	Ductile Iron, EPDM Encapsulated	
Wedge Nut	Stainless Steel	AISI 304
Stem	Stainless Steel	AISI 420
Bonnet	Ductile Iron	A536 65-45-12
Gasket	EPDM	Commercial
Packing	Graphite	Commercial
Gland	Ductile Iron	A536 65-45-12
Yoke Nut	Bronze	ASTM B62
Handwheel	Ductile Iron	A536 65-45-12
Handwheel Nut	Ductile Iron	A536 65-45-12
NPT Plug	Brass	B16, C36000
Gland Bolts	Stainless Steel	AISI 316
Bonnet Bolts	Carbon Steel	A307 B

Drawing and Picture

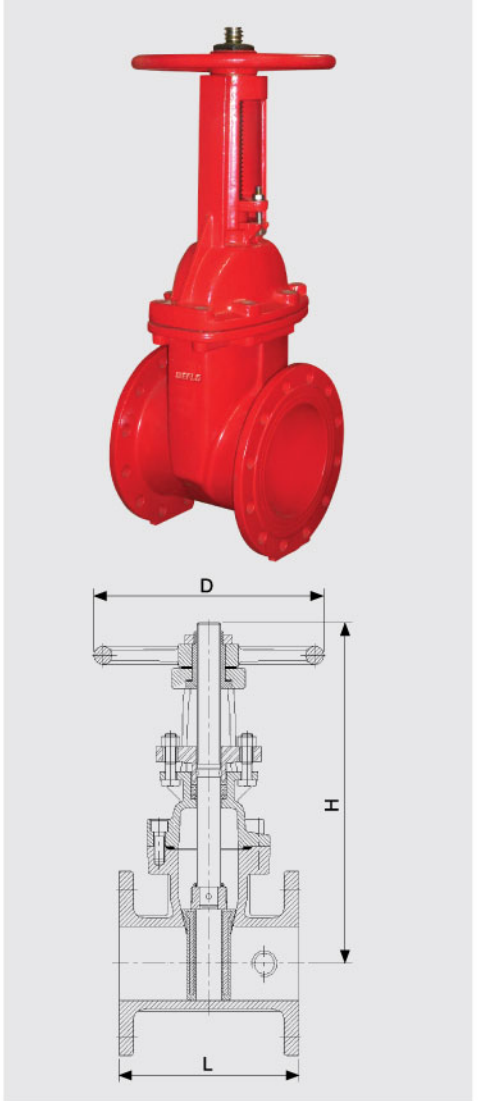

Dimensions (mm/inch)

Size	2.5"		3"		4"		5"		6"		8"		10"		12"	
	mm	inch	mm	inch	mm	inch	mm	inch	mm	inch	mm	inch	mm	inch	mm	inch
L	190.5	7-1/2	203	8	229	9	254	10	267	10-1/2	292	11-1/2	330	13	356	14
H(Open)	415	16-5/8	480	18-7/8	550	21-5/8	655	25-4/5	740	29-1/8	930	36-5/8	1130	44-1/2	1320	52
H(Close)	350	13-3/4	400	15-3/4	450	17-3/4	530	20-7/8	590	23-1/4	730	28-3/4	880	34-3/4	1020	40-1/6
D	184	7-1/4	254	10	254	10	305	12	305	12	356	14	445	17-1/2	445	17-1/2
Weigh(kg)	20		25		30		42		50		77		120		170	



OS&Y RESILIENT SEALED GATE VALVE GROOVE ENDS 300PSI FIG · F0122-300

Specification

- Valves comply with AWWA C515
- Valves with an indicator post flange and a 2" square wrench nut.
- Triple O-rings stem seal.
- NPT brass plug on body
- Groove to Metric or AWWA C606 standard
- FM and UL approved

Working Pressure

- 300PSI
- 200PSI and 250PSI available on request

Working Temperature

- 0.6°C to 52°C

Corrosion Protection

- Internally and externally fusion bonded epoxy powder coated (FBE).

Notes: Design and material are subject to change without notice.

Material Specification

Part Name	Material	ASTM Spec.
Body	Ductile Iron	A536 65-45-12
Wedge	Ductile Iron with EPDM Coated	
Wedge Nut	Bronze	ASTM B62
Stem	Stainless Steel	AISI 420
Thrust Collar	Bronze	ASTM B62
Bonnet	Ductile Iron	A536 65-45-12
Gasket	EPDM	Commercial
Gland	Ductile Iron	A536 65-45-12
O-ring	EPDM	Commercial
Post Flange	Ductile Iron	A536 65-45-12
Operating Nut	Ductile Iron	A536 65-45-12
NPT Plug	Brass	B16, C36000
Indicator Flange Bolts	Stainless Steel	AISI 316
Bonnet Bolts	Carbon Steel	A307 B

Drawing and Picture

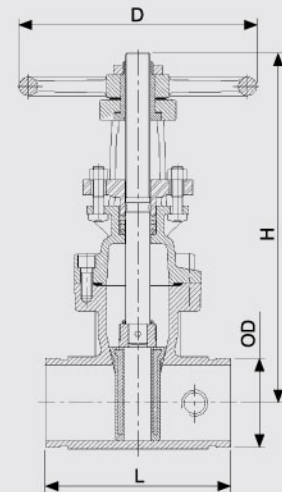

Dimensions (mm/inch)

Size	2.5"		3"		4"		5"		6"		8"		10"		12"	
	mm	inch	mm	inch	mm	inch	mm	inch	mm	inch	mm	inch	mm	inch	mm	inch
OD	73.0	2-7/8	88.9	3-1/2	114.3	4-1/2	139.7	5-1/2	165.1	6-1/2	219.1	8-5/8	273.0	10-3/4	323.9	12-3/4
	76.1	3					141.3	5-9/16	168.3	6-5/8						
L	190.5	7-1/2	203	8	229	9	254	10	267	10-1/2	292	11-1/2	330	13	356	14
H(Open)	415	16-5/8	480	18-7/8	550	21-5/8	655	25-4/5	740	29-1/8	930	36-5/8	1130	44-1/2	1320	52
H(Close)	350	13-3/4	400	15-3/4	450	17-3/4	530	20-7/8	590	23-1/4	730	28-3/4	880	34-3/4	1020	40-1/6
D	184	7-1/4	254	10	254	10	305	12	305	12	12	14	445	17-1/2	445	17-1/2
Weigh(kg)	13.3		17.5		28		40.5		43.5		68		113		153	

NRS RESILIENT SEALED GATE VALVE FLANGE ENDS 200PSI **FIG · F0211-200**

Specification

- Valves comply with AWWA C515.
- No rising stem.
- With indicator post flange and a 2" square operating nut.
- Triple O-ring stem seal.
- NPT brass plug on body.
- Flange designed to EN1092-2 PN10 / PN16, ANSI B16.1 Class125 (Others available on request) .
- FM and UL approved.

Working Pressure

- 200PSI

Working Temperature

- 0.6°C to 52°C

Corrosion Protection

- Internally and externally fusion bonded epoxy powder coated (FBE).

Notes: Design and material are subject to change without notice.

Material Specification

Part Name	Material	ASTM Spec.
Body	Ductile Iron	A536 65-45-12
Wedge	Ductile Iron with EPDM Coated	
Wedge Nut	Bronze	ASTM B62
Stem	Stainless Steel	AISI 420
Thrust Collar	Bronze	ASTM B62
Bonnet	Ductile Iron	A536 65-45-12
Gasket	EPDM	Commercial
Gland	Ductile Iron	A536 65-45-12
O-ring	EPDM	Commercial
Post Flange	Ductile Iron	A536 65-45-12
Operating Nut	Ductile Iron	A536 65-45-12
NPT Plug	Brass	B16, C36000
Indicator Flange Bolts	Stainless Steel	AISI 316
Bonnet Bolts	Carbon Steel	A307 B

Drawing and Picture

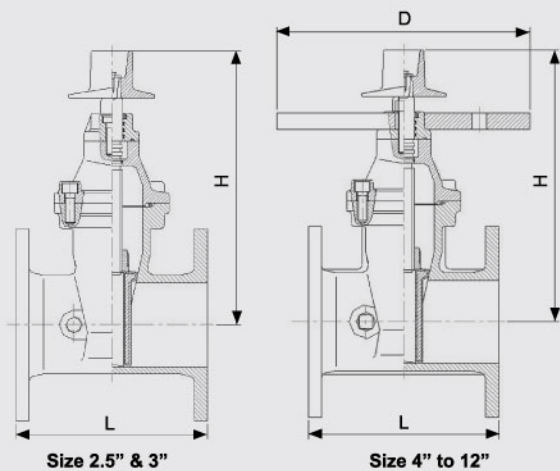

Dimensions (mm/inch)

Size	2-1/2"		3"		4"		5"		6"		8"		10"		12"	
	mm	inch	mm	inch	mm	inch	mm	inch	mm	inch	mm	inch	mm	inch	mm	inch
L	190.5	7-1/2	203	8	229	9	254	10	267	10-1/2	292	11-1/2	330	13	356	14
H	270	10-5/8	296	11-5/8	350	13-3/4	410	16-1/8	455	17-15/16	545	21-7/16	645	25-3/8	730	28-3/4
D	--	--	--	--	305	12	305	12	305	12	305	12	305	12	305	12
Weigh(kg)	16.5		23		30		35		50		75		110		164	

NRS RESILIENT SEALED GATE VALVE FLANGE ENDS 250PSI FIG · F0211-250

Specification

- Valves comply with AWWA C515.
- No rising stem.
- With indicator post flange and a 2" square operating nut.
- Triple O-ring stem seal.
- NPT brass plug on body.
- Flange designed to EN1092-2 PN10 / PN16, ANSI B16.1 Class125
(Others available on request) .
- FM and UL approved.

Working Pressure

- 250PSI

Working Temperature

- 0.6°C to 52°C

Corrosion Protection

- Internally and externally fusion bonded epoxy powder coated (FBE).

Notes: Design and material are subject to change without notice.

Material Specification

Part Name	Material	ASTM Spec.
Body	Ductile Iron	A536 65-45-12
Wedge	Ductile Iron with EPDM Coated	
Wedge Nut	Bronze	ASTM B62
Stem	Stainless Steel	AISI 420
Thrust Collar	Bronze	ASTM B62
Bonnet	Ductile Iron	A536 65-45-12
Gasket	EPDM	Commercial
Gland	Ductile Iron	A536 65-45-12
O-ring	EPDM	Commercial
Post Flange	Ductile Iron	A536 65-45-12
Operating Nut	Ductile Iron	A536 65-45-12
NPT Plug	Brass	B16, C36000
Indicator Flange Bolts	Stainless Steel	AISI 316
Bonnet Bolts	Carbon Steel	A307 B

Drawing and Picture

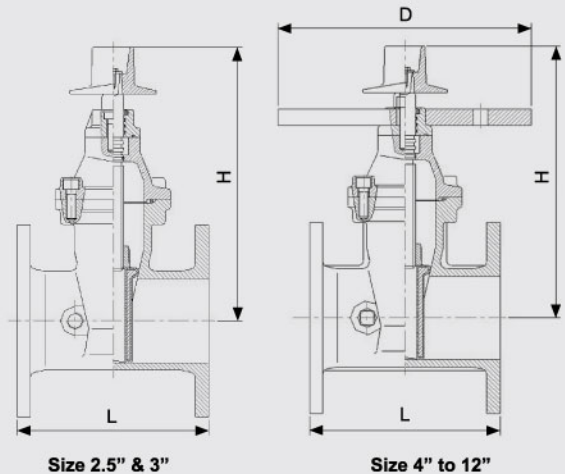

Dimensions (mm/inch)

Size	2-1/2"		3"		4"		5"		6"		8"		10"		12"	
	mm	inch	mm	inch	mm	inch	mm	inch	mm	inch	mm	inch	mm	inch	mm	inch
L	190.5	7-1/2	203	8	229	9	254	10	267	10-1/2	292	11-1/2	330	13	356	14
H	270	10-5/8	296	11-5/8	350	13-3/4	410	16-1/8	455	17-15/16	545	21-7/16	645	25-3/8	730	28-3/4
D	--	--	--	--	305	12	305	12	305	12	305	12	305	12	305	12
Weigh(kg)	16.5		23		30		35		50		75		110		164	

NRS RESILIENT SEALED GATE VALVE FLANGE ENDS 300PSI **FIG · F0211-300**

Specification

- Valves comply with AWWA C515.
- No rising stem.
- With indicator post flange and a 2" square operating nut.
- Triple O-ring stem seal.
- NPT brass plug on body.
- Flange designed to EN1092-2 PN10 / PN16, ANSI B16.1 Class125 (Others available on request) .
- FM and UL approved.

Working Pressure

- 300PSI

Working Temperature

- 0.6°C to 52°C

Corrosion Protection

- Internally and externally fusion bonded epoxy powder coated (FBE).

Notes: Design and material are subject to change without notice.

Material Specification

Part Name	Material	ASTM Spec.
Body	Ductile Iron	A536 65-45-12
Wedge	Ductile Iron with EPDM Coated	
Wedge Nut	Bronze	ASTM B62
Stem	Stainless Steel	AISI 420
Thrust Collar	Bronze	ASTM B62
Bonnet	Ductile Iron	A536 65-45-12
Gasket	EPDM	Commercial
Gland	Ductile Iron	A536 65-45-12
O-ring	EPDM	Commercial
Post Flange	Ductile Iron	A536 65-45-12
Operating Nut	Ductile Iron	A536 65-45-12
NPT Plug	Brass	B16, C36000
Indicator Flange Bolts	Stainless Steel	AISI 316
Bonnet Bolts	Carbon Steel	A307 B

Drawing and Picture

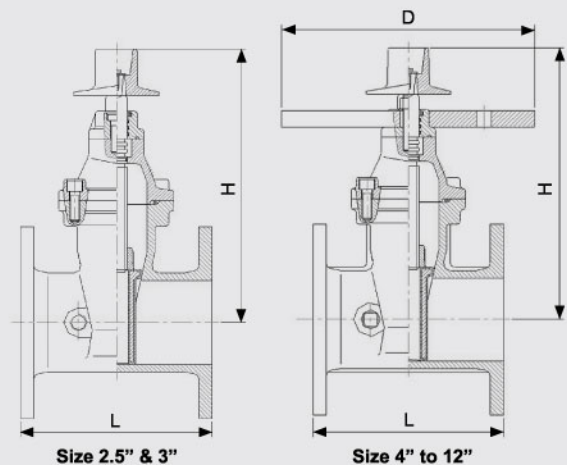

Dimensions (mm/inch)

Size	2-1/2"		3"		4"		5"		6"		8"		10"		12"	
	mm	inch	mm	inch	mm	inch	mm	inch	mm	inch	mm	inch	mm	inch	mm	inch
L	190.5	7-1/2	203	8	229	9	254	10	267	10-1/2	292	11-1/2	330	13	356	14
H	270	10-5/8	296	11-5/8	350	13-3/4	410	16-1/8	455	17-15/16	545	21-7/16	645	25-3/8	730	28-3/4
D	--	--	--	--	305	12	305	12	305	12	305	12	305	12	305	12
Weigh(kg)	16.5		23		30		35		50		75		110		164	



NRS RESILIENT SEALED GATE VALVE

FL×MJ ENDS 300PSI

FIG · F0213-300

Specification

- Valves comply with AWWA C515
- No rising stem
- With indicator post flange and a 2" operating nut
- Triple O-ring stem seal
- NPT plug on body
- Flange designed to EN1092-2 PN10 / PN16, ANSI B16.1 Class125 (Others available on request)
- With the mechanical joint designed to ANSI/AWWA C153/A21.53.
- FM and UL approved

Working Pressure

- 300PSI
- 200PSI and 250PSI available on request

Working Temperature

- 0.6°C to 52°C

Corrosion Protection

- Internally and externally fusion bonded epoxy powder coated (FBE).

Notes: Design and material are subject to change without notice.

Material Specification

Part Name	Material	ASTM Spec.
Body	Ductile Iron	A536 65-45-12
Wedge	Ductile Iron with EPDM Coated	
Wedge Nut	Bronze	ASTM B62
Stem	Stainless Steel	AISI 420
Thrust Collar	Bronze	ASTM B62
Bonnet	Ductile Iron	A536 65-45-12
Gasket	EPDM	Commercial
Gland	Ductile Iron	A536 65-45-12
O-ring	EPDM	Commercial
Post Flange	Ductile Iron	A536 65-45-12
Operating Nut	Ductile Iron	A536 65-45-12
NPT Plug	Brass	B16, C36000
Indicator Flange Bolts	Stainless Steel	AISI 316
Bonnet Bolts	Carbon Steel	A307 B

Drawing and Picture

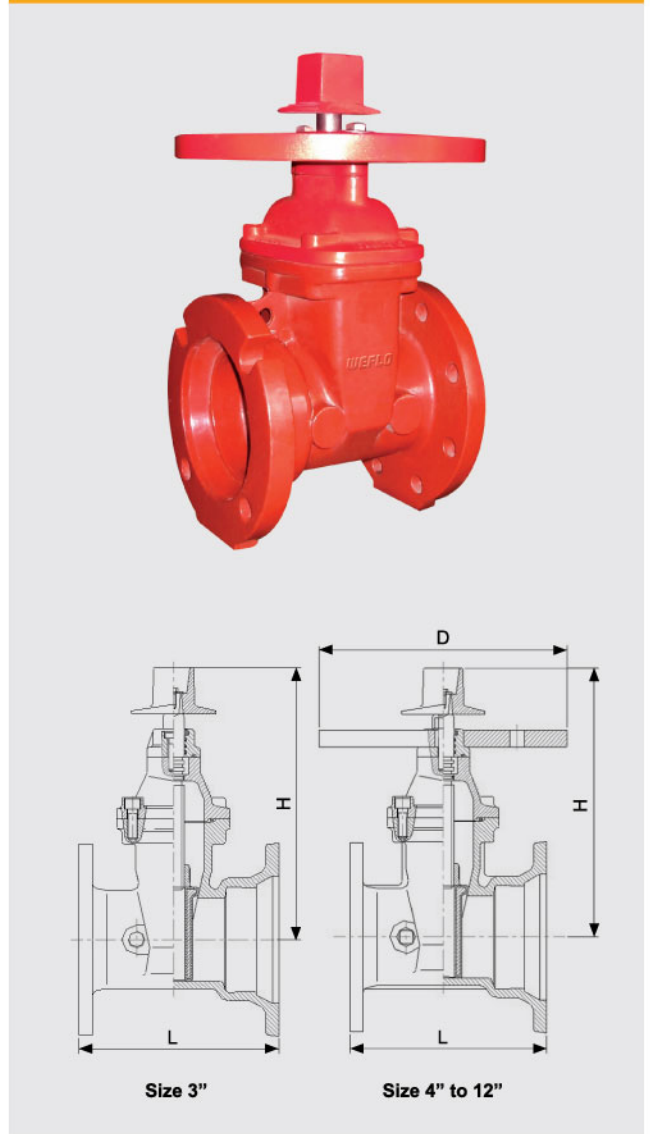

Dimensions (mm/inch)

Size	3"		4"		6"		8"		10"		12"	
	mm	inch	mm	inch	mm	inch	mm	inch	mm	inch	mm	inch
L	222	8-3/4	241.5	9-1/2	279.5	11	305	12	352.5	13-7/8	367	14-7/16
H	296	11-5/8	350	13-3/4	455	17-15/16	545	21-7/16	645	25-3/8	730	28-3/4
D	--	--	305	12	305	12	305	12	305	12	305	12
Weigh(kg)	21.4		31		51.5		77.5		114		169.5	

**NRS RESILIENT SEALED GATE VALVE
GROOVE ENDS 300PSI
FIG · F0222-300**

Specification

- Valves comply with AWWA C515
- Valves with an indicator post flange and a 2" square wrench nut.
- Triple O-rings stem seal.
- NPT brass plug on body
- Groove to Metric or AWWA C606 standard
- FM and UL approved

Working Pressure

- 300PSI
- 200PSI and 250PSI available on request

Working Temperature

- 0.6°C to 52°C

Corrosion Protection

- Internally and externally fusion bonded epoxy powder coated (FBE).

Notes: Design and material are subject to change without notice.

Material Specification

Part Name	Material	ASTM Spec.
Body	Ductile Iron	A536 65-45-12
Wedge	Ductile Iron with EPDM Coated	
Wedge Nut	Bronze	ASTM B62
Stem	Stainless Steel	AISI 420
Thrust Collar	Bronze	ASTM B62
Bonnet	Ductile Iron	A536 65-45-12
Gasket	EPDM	Commercial
Gland	Ductile Iron	A536 65-45-12
O-ring	EPDM	Commercial
Post Flange	Ductile Iron	A536 65-45-12
Operating Nut	Ductile Iron	A536 65-45-12
NPT Plug	Brass	B16, C36000
Indicator Flange Bolts	Stainless Steel	AISI 316
Bonnet Bolts	Carbon Steel	A307 B

Drawing and Picture

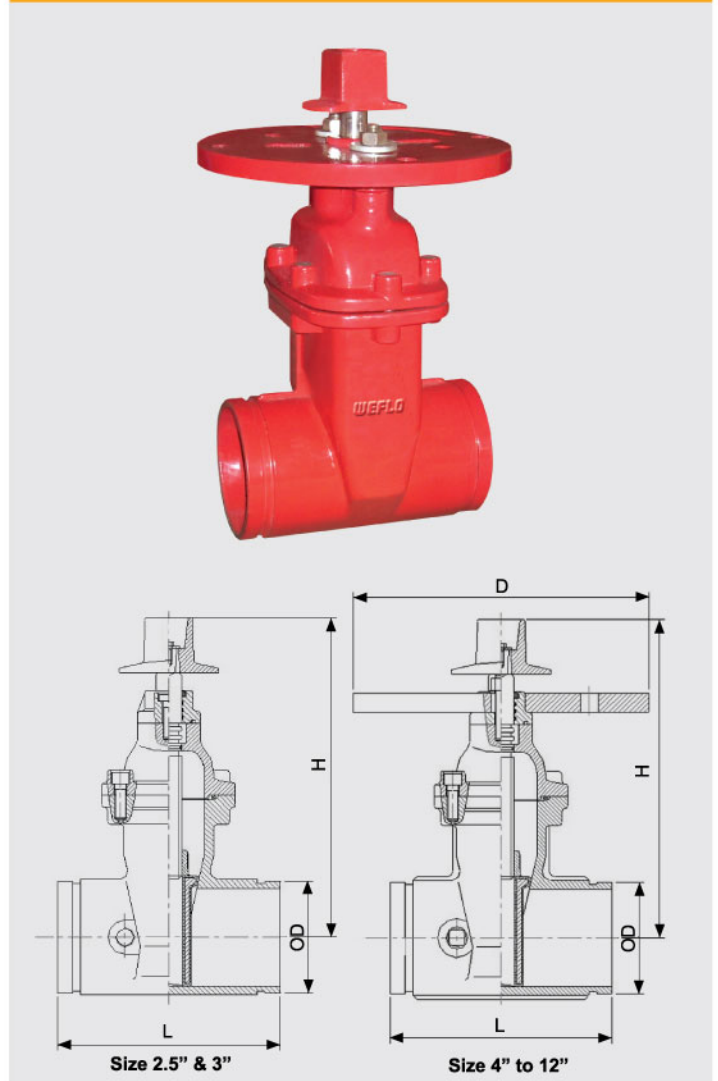

Dimensions (mm/inch)

Size	2-1/2"		3"		4"		5"		6"		8"		10"		12"	
	mm	inch	mm	inch	mm	inch	mm	inch	mm	inch	mm	inch	mm	inch	mm	inch
OD	73.0	2-7/8	88.9	3-1/2	114.3	4-1/2	139.7	5-1/2	165.1	6-1/2	219.1	8-5/8	273.0	10-3/4	323.9	12-3/4
	76.1	3					141.3	5-9/16	168.3	6-5/8						
L	190.5	7-1/2	203	8	229	9	254	10	267	10-1/2	292	11-1/2	330	13	356	14
H	270	10-5/8	296	11-5/8	350	13-3/4	410	16-1/8	455	17-15/16	545	21-7/16	645	25-3/8	730	28-3/4
D	--	--	--	--	305	12	305	12	305	12	305	12	305	12	305	12
Weight(kg)	11.3		13.6		28		36.5		43.5		66		103		144	



NRS RESILIENT SEALED GATE VALVE MJ×MJ ENDS 300PSI FIG · F0233-300

Specification

- Valves comply with AWWA C515
- No rising stem
- With indicator post flange and a 2" operating nut
- Triple O-ring stem seal
- NPT plug on body
- With the mechanical joint designed to ANSI/AWWA C153/A21.53.
- FM and UL approved

Working Pressure

- 300PSI
- 200PSI and 250PSI available on request

Working Temperature

- 0.6°C to 52°C

Corrosion Protection

- Internally and externally fusion bonded epoxy powder coated (FBE).

Notes: Design and material are subject to change without notice.

Material Specification

Part Name	Material	ASTM Spec.
Body	Ductile Iron	A536 65-45-12
Wedge	Ductile Iron with EPDM Coated	
Wedge Nut	Bronze	ASTM B62
Stem	Stainless Steel	AISI 420
Thrust Collar	Bronze	ASTM B62
Bonnet	Ductile Iron	A536 65-45-12
Gasket	EPDM	Commercial
Gland	Ductile Iron	A536 65-45-12
O-ring	EPDM	Commercial
Post Flange	Ductile Iron	A536 65-45-12
Operating Nut	Ductile Iron	A536 65-45-12
NPT Plug	Brass	B16, C36000
Indicator Flange Bolts	Stainless Steel	AISI 316
Bonnet Bolts	Carbon Steel	A307 B

Drawing and Picture

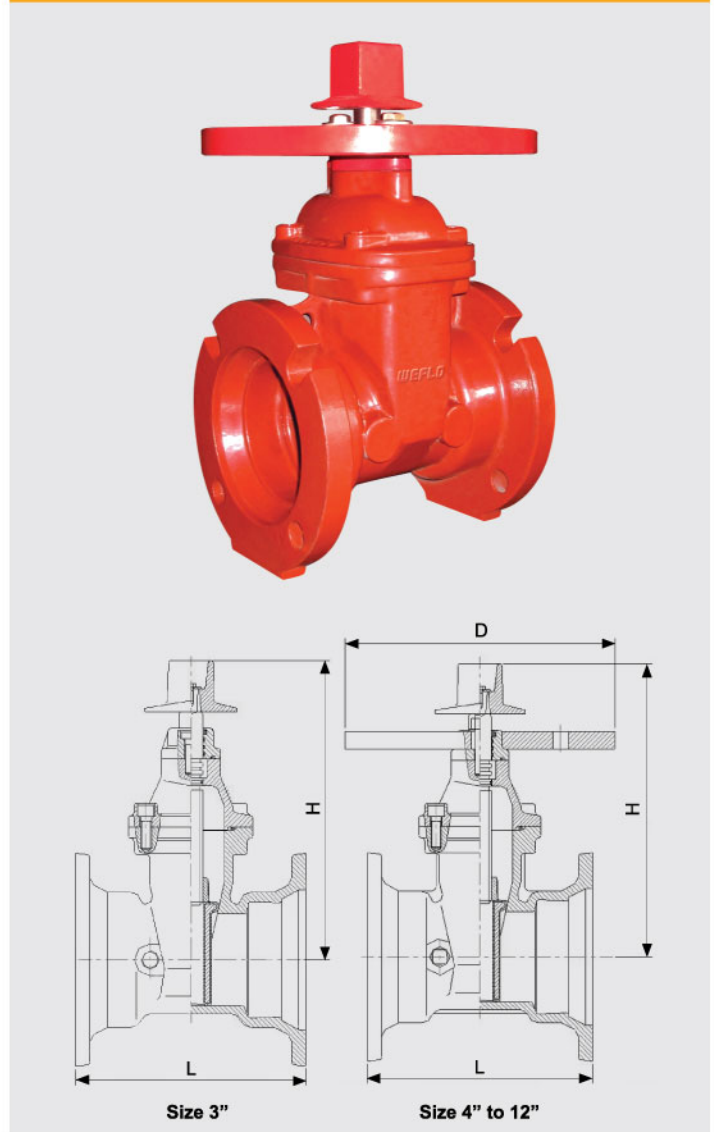

Dimensions (mm/inch)

Size	3"		4"		6"		8"		10"		12"	
	mm	inch	mm	inch	mm	inch	mm	inch	mm	inch	mm	inch
L	241	9-1/2	254	10	292	11-1/2	318	12-1/2	375	14-3/4	378	14-7/8
H	296	11-5/8	350	13-3/4	455	17-15/16	545	21-7/16	645	25-3/8	730	28-3/4
D	--	--	305	12	305	12	305	12	305	12	305	12
Weigh(kg)	20.4		32		52.5		80		118		175	

VERTICAL INDICATOR POST FIG · F0600-IP

Specification

- Indicates if the valve is in the open or shut position.
 - The indicator post provides a means to operate a buried or otherwise inaccessible valve.
 - The adjustment range of the indicator post is 34.5" to suit the deeper buried valve and can be easily adjusted in the field.
 - The wrench handle fits over a "U" bracket on the barrel, and may be fixed with a padlock to secure the operating wrench to the barrel.
 - Can be supplied to open left or right.
- FM and UL approved.

Material Specification

No.	Component	Material
1	Hex Cap Screw	Carbon Steel ASTM A307B
2	Hex Nut	Carbon Steel ASTM A307B
3	Crane Coupling	Ductile Iron ASTM A536 Gr. 65-45-12
4	Cotter Pin	Stainless Steel AISI 304
5	Base Flange	Cast Iron ASTM A126 Class B
6	Hex Nut	Carbon Steel ASTM A307B
7	Hex Cap Screw	Carbon Steel ASTM A307B
8	Standpipe	Carbon Steel ASTM A53
9	Stem 1" Square	Carbon Steel AISI11045
10	Body	Cast Iron ASTM A126 Class B
11	Locking Wrench	Bronze ASTM B62 C83600
12	Target Carrier Nut	Cast Iron ASTM A126 Class B Stainless Steel AISI 304
13	Hex Cap Screw	Carbon Steel ASTM A307B
14	Hex Nut	Carbon Steel ASTM A307B
15	Hex Cap Screw	Carbon Steel ASTM A307B
16	Target	Cast Aluminium
17	Window Glass	Plexiglass
18	Gasket	PTFE
19	Operating Nut	Bronze ASTM B62 C83600 Stainless Steel AISI 304
20	Top Section	Cast Iron ASTM A126 Class B
21	Snap Ring	Stainless Steel AISI11066
22	Plug	Malleable Iron
23	Square Nut	Carbon Steel ASTM A307B
24	Hex Cap Screw	Carbon Steel ASTM A307B

Corrosion Protection

- Internally and externally red epoxy coated RAL3000.

Notes: Design and material are subject to change without notice.

Drawing and Picture

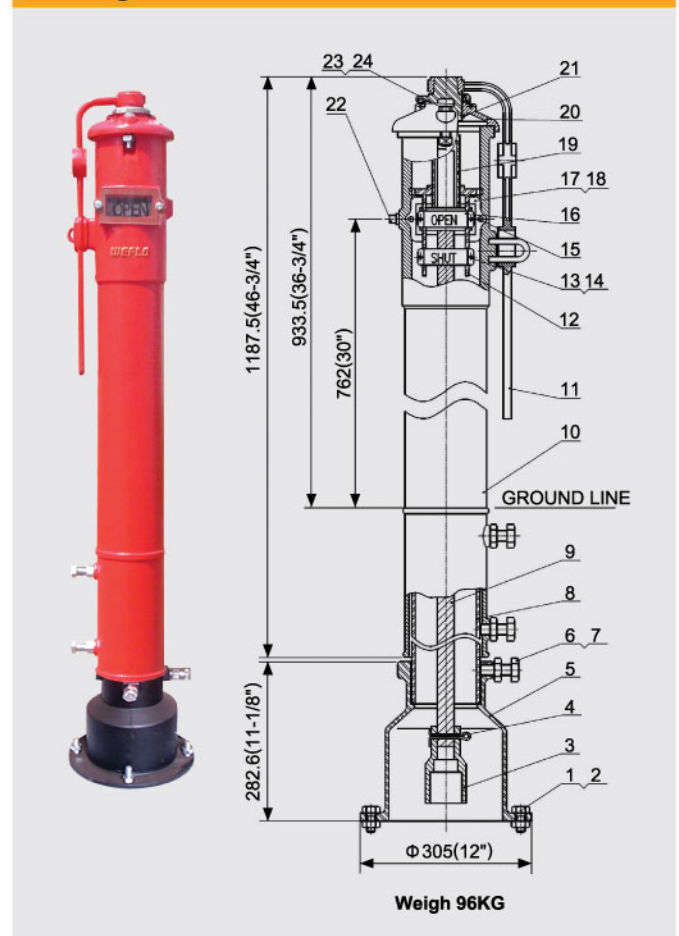

Field Adjustment

- Remove the Top Section from the top of the Indicator Post assembly.
- Cut the required stem length and adjust the Standpipe to match up to the Ground Line.
- Set the "OPEN" and "SHUT" targets for the appropriate valve size.
- Reattach the Top Section to the top of the Indicator Post assembly.



WALL INDICATOR POST FIG · F0600-WP

Specification

- Indicates if the valve is in the open or shut position.
- Used to operate a valve installed behind a wall.
- With a 12" O.D. post flange to mount on a wall.
- Operated by handwheel.
- Can be supplied to open left or right.
- FM and UL approved.

Corrosion Protection

- Internally and externally red epoxy coated RAL3000.

Notes: Design and material are subject to change without notice.

FIELD ADJUSTMENT

- Remove the Top Section from the top of the Indicator Post assembly.
- Reattach the Top Section to the top of the Indicator Post assembly.
- Set the "OPEN" and "SHUT" targets for the appropriate valve size.

Drawing and Picture

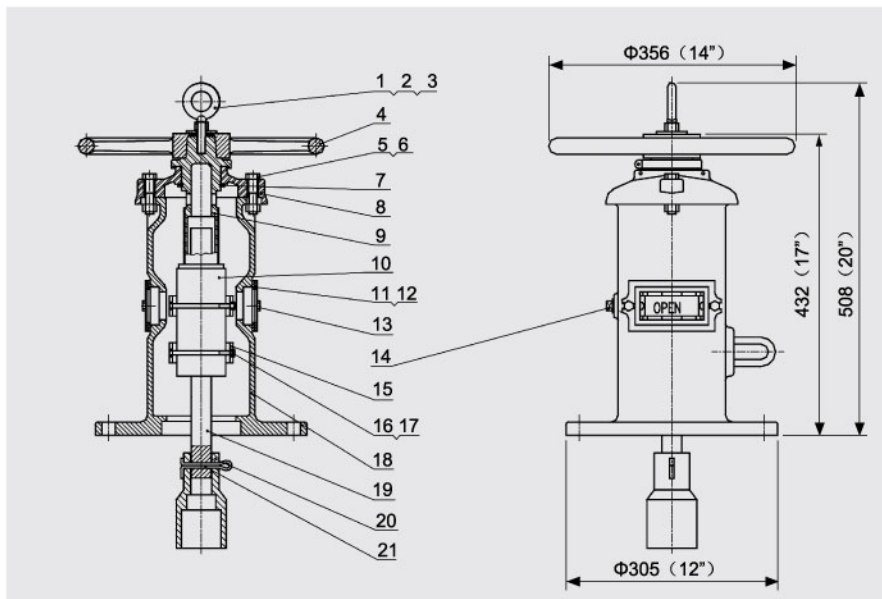

Material Specification

No.	Component	Material	No.	Component	Material
1	Eye Bolt	Carbon Steel ASTM A307B	11	Window Glass	Plexiglass
2	Hex Nut	Carbon Steel ASTM A307B	12	Gasket	PTFE
3	Washer	Carbon Steel ASTM A570 Gr. 33	13	Hex Nut	Carbon Steel ASTM A307B
4	Handwheel	Ductile Iron ASTM A536 Gr. 65-45-12	14	Plug	Malleable Iron
5	Hex Cap Screw	Carbon Steel ASTM A307B	15	Target	Cast Aluminium
6	Square Nut	Carbon Steel ASTM A307B	16	Hex Cap Screw	Carbon Steel ASTM A307B
7	Snap Ring	Stainless Steel AISI 1066	17	Hex Nut	Carbon Steel ASTM A307B
8	Cover	Cast Iron ASTM A126 Class B	18	Body	Cast Iron ASTM A126 Class B
9	Operating Nut	Bronze ASTM B62 C83600	19	Stem	Carbon Steel AISI 1045
		Stainless Steel AISI 304	20	Crane Coupling	Ductile Iron ASTM A536 Gr. 65-45-12
10	Target Carrier Nut	Bronze ASTM B62 C83600	21	Cotter Pin	Stainless Steel AISI 304
		Stainless Steel AISI 304			

SWING CHECK VALVE FLANGE ENDS 300PSI **FIG · F0311-300**

Specification

- Valves comply with AWWA C508, clear waterway design.
- Seating type is resilient material to bronze seat construction.
- Two brass plugs screwed on one side of body.
- Flanges to EN1092-PN10/PN16, ANSI B16.1 Class125.
(Other types available on request).
- FM and UL approved.

Working Pressure

- 300PSI
- 200PSI and 250PSI available on request

Working Temperature

- 0.6°C to 52°C

Corrosion Protection

- Internally and externally fusion bonded epoxy powder coated (FBE).

Notes: Design and material are subject to change without notice.

Drawing and Picture

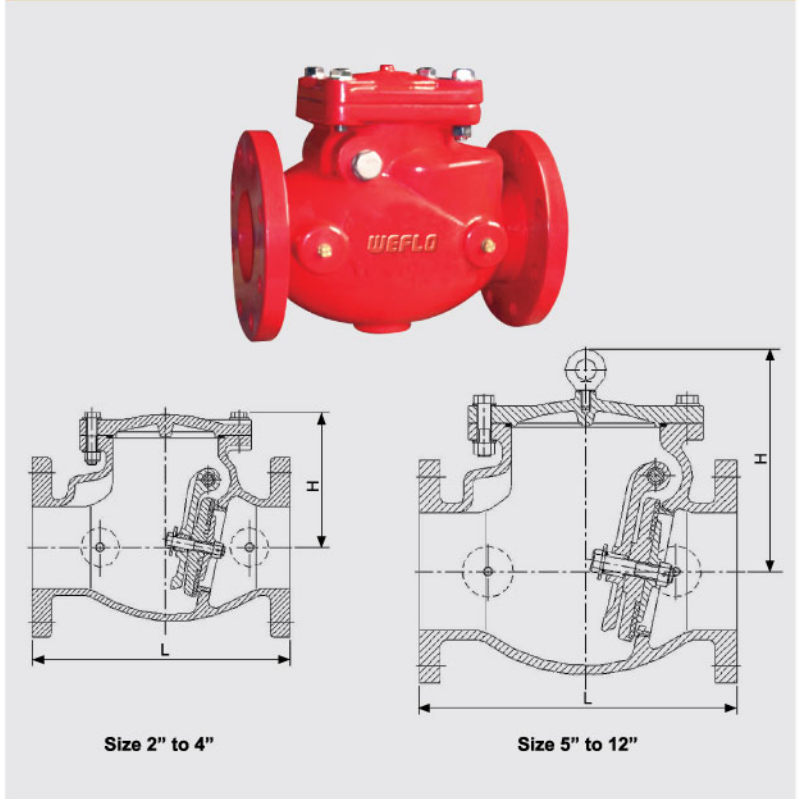

Material Specification

Part Name	Material	ASTM Spec.	Part Name	Material	ASTM Spec.
Body	Ductile Iron	A536 65-45-12	Gasket	EPDM	Commercial
Seat Ring	Bronze	ASTM B62	Hinge Pin	Stainless Steel	AISI 304
Disc Ring	EPDM	Commercial	Clapper Arm	Ductile Iron	A536 65-45-12
Disc Ring Retainer	Bronze	ASTM B62	Pin Plug	Stainless Steel	AISI 304
Retainer Bolt	Stainless Steel	AISI 304	NPT Plug	Brass	B16 C36000
Disc	Ductile Iron	A536 65-45-12	Bolt and Nut	Carbon Steel	A307 B
Bonnet	Ductile Iron	A536 65-45-12	Eyebolt	Carbon Steel	A307 B

Dimensions (mm/inch)

Size		2"	2.5"	3"	4"	5"	6"	8"	10"	12"
L	mm	203	254	279	330	356	406	495	559	660
	inch	8	10	11	13	14	16	19-1/2	22	26
H	mm	132	145	150	175	298	300	352	395	445
	inch	5-3/16	5-11/16	5-7/8	6-7/8	11-3/4	11-13/156	13-7/8	15-9/16	17-1/2
Weight(kg)		11.5	13	17	25	40	50	58.3	218	282



SWING CHECK VALVE GROOVE ENDS 300PSI FIG · F0322-300

Specification

- Seating type is resilient material to bronze seat construction.
- Full waterway design.
- Ductile iron disc, EPDM encapsulated.
- Groove dimensions comply with Metric or AWWA C606.
- FM and UL approved.

Working Pressure

- 300PSI
- 200PSI and 250PSI available on request

Working Temperature

- 0.6 °C to 52 °C

Corrosion Protection

- Internally and externally fusion bonded epoxy powder coated (FBE).

Notes: Design and material are subject to change without notice.

Material Specification

Part Name	Material	ASTM Spec.
Body	Ductile Iron	A536 65-45-12
Body Seat	Bronze	ASTM B62
Disc	DI and Rubber Encapsulated	DI+EPDM
Spindle	Stainless Steel	AISI 316
Spring	Stainless Steel	AISI 304
Plug	Stainless Steel	AISI 304
Washer	Rubber	EPDM

Drawing and Picture

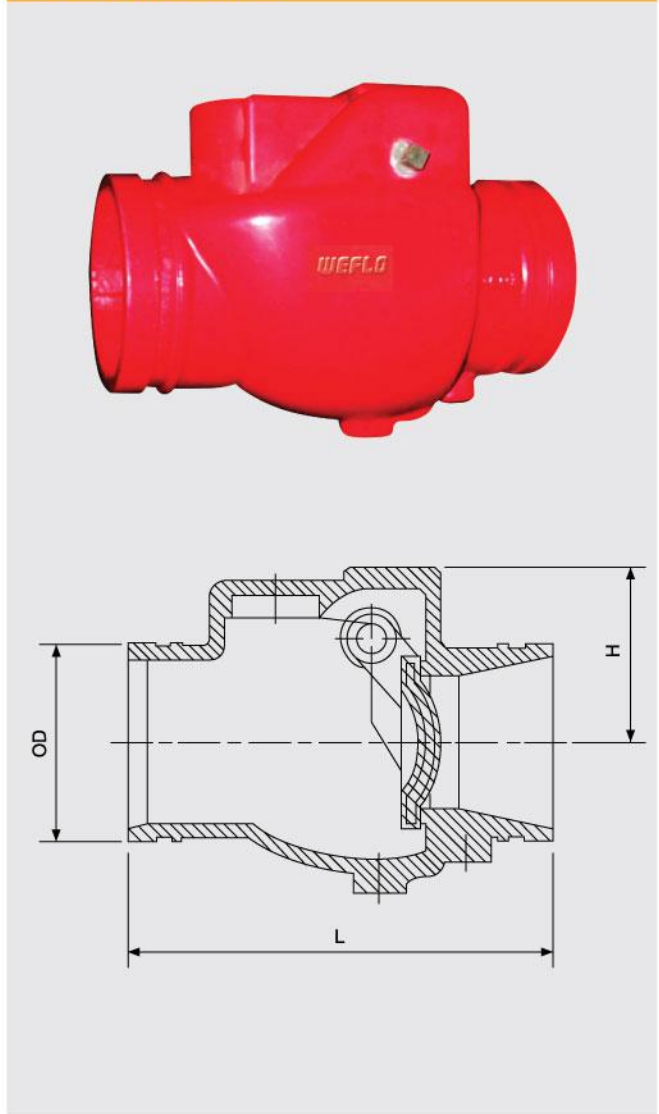

Dimensions (mm/inch)

Size	2.5"		3"		4"		5"		6"		8"		10"		12"	
	mm	inch	mm	inch	mm	inch	mm	inch	mm	inch	mm	inch	mm	inch	mm	inch
OD	73.0	2-7/8	88.9	3-1/2	114.3	4-1/2	139.7	5-1/2	165.1	6-1/2	219.1	8-5/8	273	10-3/4	323.9	12-3/4
	76.1	3					141.3	5-9/16	168.3	6-5/8						
L	203.2	8	213	8-3/8	245	9-5/8	267	10-1/2	292	11-1/2	356	14	432	17	495	19-1/2
H	74.5	2-15/16	78	3-1/16	102	4	112	4-7/16	133.5	5-1/4	160	6-5/16	195	7-11/16	215	8-1/2

DOUBLE DOOR CHECK VALVE
175PSI
FIG · F0411-175

Specification

- The extremely short face to face dimension and compact design of this valve allow installation and service in tight spaces.
- Spring assisted for better dynamic behaviour.
- Soft seated for perfect tightness even at low differential pressure.
- Flanges ANSI B16.1 Class125.
- UL listed.

Working Pressure

- 175PSI

Working Temperature

- -10°C to 120°C

Corrosion Protection

- Internally and externally spray-painted or fusion bonded epoxy powder coated (FBE).

Notes: Design and material are subject to change without notice.

Material Specification

Component	Material	Component	Material
Body	Cast Iron ASTM A126 Class B	Washer	PTFE
Stop Pin	Stainless Steel AISI 416	Spacer	PTFE
Hinge Pin	Stainless Steel AISI 416	Disc	Stainless Steel ASTM CF8
Seat	EPDM	Spring	Stainless Steel AISI 304
Pin Retainer	Stainless Steel AISI 416	Lifting Hook	Carbon Steel (Not Shown, only for 8", 10" & 12")
Gasket	PTFE		

Dimensions (mm/inch)

Size	100mm / 4"		150mm / 6"		200mm / 8"		250mm / 10"		300mm / 12"	
	mm	inch	mm	inch	mm	inch	mm	inch	mm	inch
A	93	3-11/16	105	4-1/8	121	4-3/4	154	6-1/16	187	7-3/8
B	172	6-3/4	220	8-11/16	280	11	340	13-3/8	410	16-1/8
C	136	5-3/8	178	7	230	9-1/16	285	11-1/4	338	13-5/16
Weigh(kg)	8.4		13.5		23		42		68	

Drawing and Picture

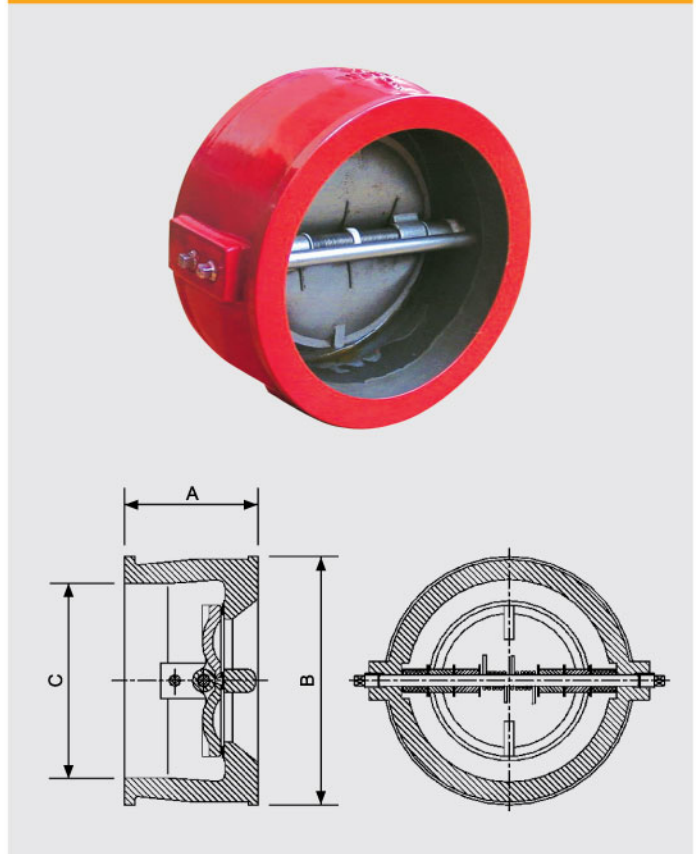

Y-STRAINER FLANGE ENDS 175PSI FIG · F0511-175

Specification

- NPT or BSPT blowoff outlet on cover. Blowoff outlets are finished with plugs.
- Screens are perforated 304 stainless steel with spot welded seam.
- Recessed seat in body assures accurate screen alignment.
- Flanges to EN1092-2 PN16, ANSI B16.1 Class125 (Other types available on request).
- UL listed.

Working Pressure

- 175PSI

Working Temperature

- -10°C to 120°C

Corrosion Protection

- Internally and externally spray-painted or fusion bonded epoxy powder coated (FBE).

Notes: Design and material are subject to change without notice.

Material Specification

Component	Material
Body	Cast Iron ASTM A126 Class B
Cover	Cast Iron ASTM A126 Class B
Screen	Stainless Steel AISI 304
Gasket	PTFE/Graphite
Plug	Ductile Iron ASTM A536 Gr. 65-45-12

Standard Screens

Size (mm/inch)	Hole Dia.(mm)	Free Flow Area(%)
65(2-1/2")	3	53.6
80-125(3" -5")	4.3	46.3
150-250 (6"-10")	6.0	54.5
300 (12")	6.3	57.2

Dimensions (mm/inch)

Size	A		B		Plug Size (NPT Thread)	Weight(kg)
	mm	inch	mm	inch		
65mm / 2-1/2"	273.0	10-3/4	135.0	5-5/16	1"	14
80mm / 3"	295.0	11-5/8	215.0	8-1/2	1"	17.3
100mm / 4"	352.0	13-7/8	245.0	9-5/8	1"	32
125mm / 5"	416.0	16-3/8	295.0	11-5/8	1-1/4"	47.5
150mm / 6"	470.0	18-1/2	320.0	12-5/8	1-1/2"	62.5
200mm / 8"	543.0	21-3/8	415.0	16-3/8	1-1/2"	107.5
250mm / 10"	660.0	26	485.0	19-1/8	2"	175
300mm / 12"	770.0	30-5/16	560.0	22-1/16	2"	253

Drawing and Picture

